

MAIN CONCESSION EQUIPMENT FIXTURE PLAN

ITEM NO.	SUPPLIER	EQUIPMENT LIST	ELECTRICAL						NOTES	MECHANICAL						NOTES	
			VOLTS	Ph	K.W.	H.P.	LOAD (AMP)	⚡		GAS		WATER			EXHAUST		
										LOAD MBTU	SIZE	HW	CW	W	CFM		SIZE
1	HE	WALL MOUNT HAND SINK										13	13	38			
2	HE	EXHAUST CANOPY	120	1					LIGHTS - SEE NOTE #13						3700	457 x 254	SECOND DUCT CONN. @ 457 x 254
3	HE	DEEP FRYER - 2ea	120	1			15	⚡	UTILITY OUTLET - 2ea CONN. REQ'D	110	19						2ea CONNECTIONS REQUIRED
4	HE	SPREADER TABLE															
5	HE	BROILER								110	19						
6	HE	SS EQUIPMENT STAND FOR BROILER															
7	HE	TWO BURNER RANGE w/ GRIDDLE								110	19						
8	HE	DOUBLE DOOR COOLER - 2ea	115	1	1/3	7.3	⚡		DEDICATED CIRCUIT - 2ea CONN. REQ'D								
9	HE	DOUBLE DOOR FREEZER - 2ea	115	1	3/4	11	⚡		DEDICATED CIRCUIT - 2ea CONN. REQ'D								
10	HE	3 COMPARTMENT PREPARATION SINK												38			CONNECT TO G.T. #30
11	HE	FAUCET										13	13				
12	HE	SS PREPARATION TABLE															
13	HE	PUSH BUTTON HOT BEVERAGE DISPENSER - 2ea	115	1	1.8				2 CONNECTIONS REQUIRED				13				CON. FROM ITEM #16 - 2ea CON. REQ'D
14	HE	FIRE SUPPRESSION SYSTEM	120	1					CONNECT w/ ALARM								
15	HE	HOT WATER DISPENSER	115	1	1.8		15	⚡	2 CONNECTIONS REQUIRED				13				CON. FROM ITEM #16 - 2ea CON. REQ'D
16	HE	WATER FILTER										13					CONNECT TO ITEM #13 & #15
17	HE	SS WALL SHELVES															
18	MW	MILLWORK COUNTER w/ UNDER SHELVING															
19	O	POS SYSTEM	115	1				⚡	DEDICATED CIRCUIT - ALSO; DATA								
20	HE	HOT DOG GRILL w/ BUN WARMER	120	1	1.15		9.6	⚡									
21	HE	MICROWAVE	120	1	1.0		13.4	⚡									
22	HE	POPCORN MACHINE	120	1			10	⚡									
23	HE	NACHO MACHINE	120	1			15	⚡									
24	HE	CONVEYOR TOASTER	120	1	1.8		15	⚡									
25	O	POS SYSTEM	115	1				⚡	DEDICATED CIRCUIT - ALSO; DATA								
26	HE	MOBILE GARBAGE CAN															
27	HE	UNDERCOUNTER DISHWASHER	208	1			30.5					13		38			
28	MW	MILLWORK COUNTER															
29	MW	MILLWORK CABINET															
30	Me	GREASE TRAP															

GENERAL NOTES CONTINUED:
13. ELECTRICAL CONTRACTOR TO WIRE INDIVIDUAL LIGHTS, INSIDE ITEM #2. THIS LIGHTING CIRCUIT MUST BE CONNECTED TO A CONVENIENTLY LOCATED LIGHT SWITCH OR OR TO THE KITCHEN LIGHTING SYSTEM.

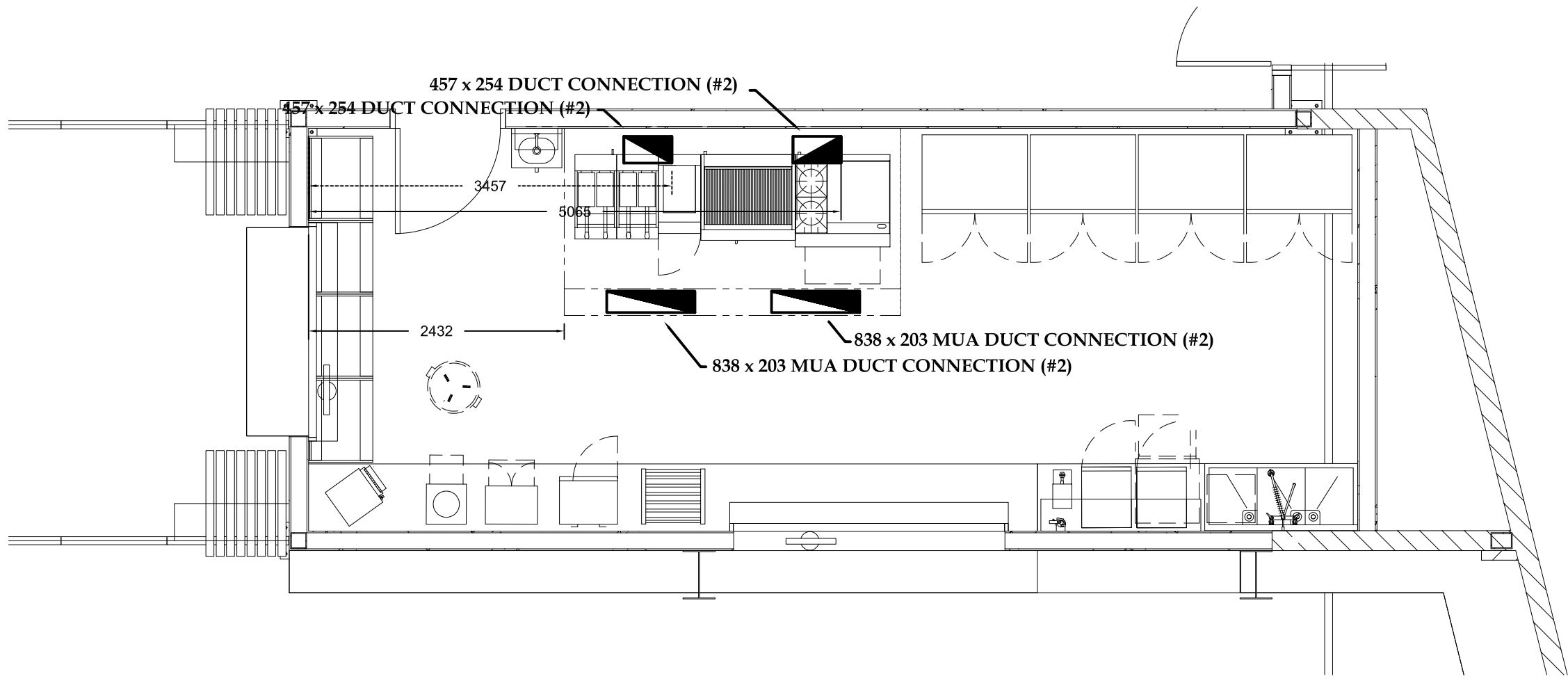

MECHANICAL SERVICE PLAN - DUCT CONNECTIONS

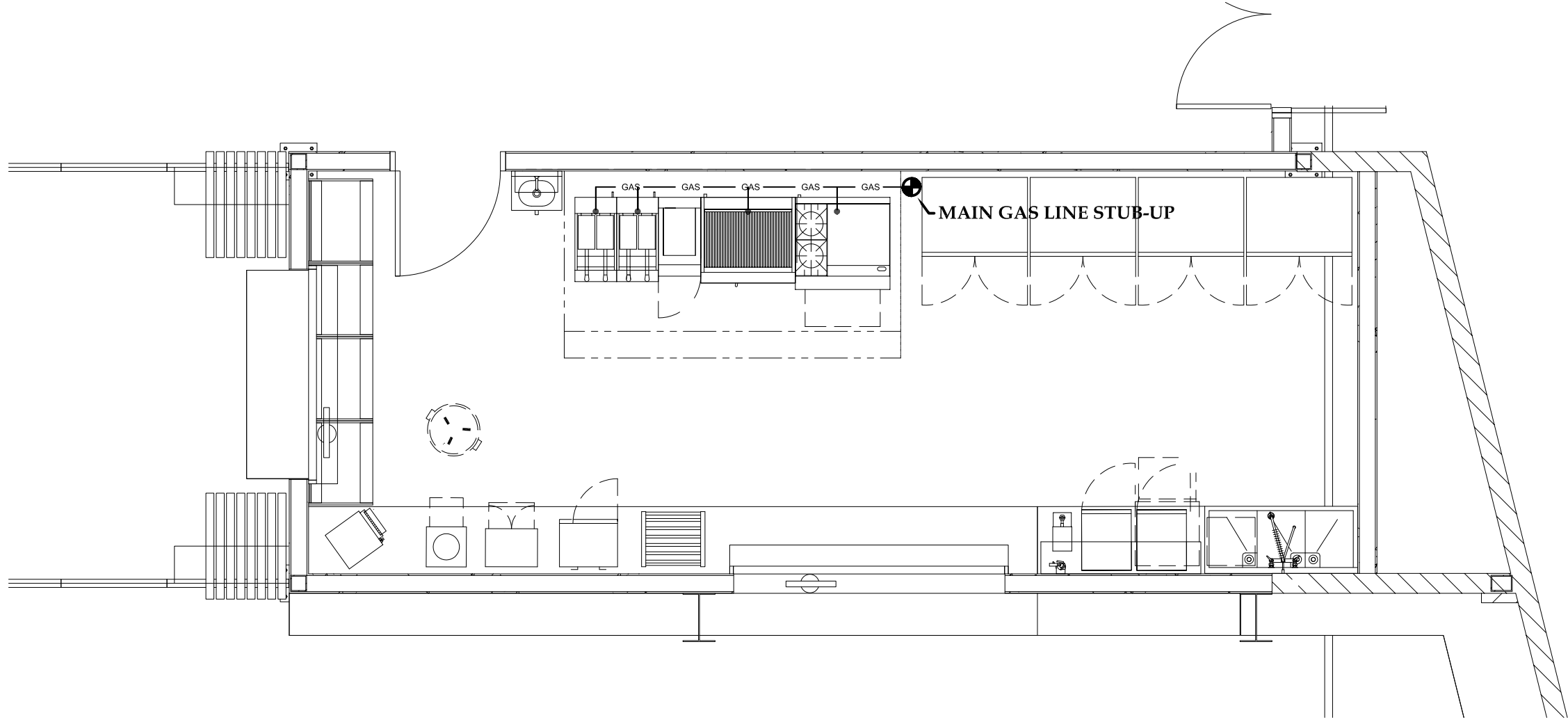

MECHANICAL SERVICE PLAN - GAS LINE DETAIL

GENERAL NOTES:

1. ALL EQUIPMENT SET IN PLACE BY KITCHEN EQUIPMENT CONTRACTOR, LEVELED FLASHED AND MADE READY FOR FINAL CONNECTIONS BY PLUMBER, ELECTRICIAN, GAS, STEAM AND OTHER TRADES.

2. ALL SUBTRADES TO CHECK WITH KITCHEN EQUIPMENT CONTRACTOR TO VERIFY FINAL ROUGH-IN DATA BEFORE COMMENCING WORK.

3. A MINIMUM CLEAR OPENING OF 3FT. (915mm) WIDE X 7FT. (2134mm) HIGH MUST BE PROVIDED FOR ENTRY AND PLACING OF EQUIPMENT.

4. CONDUITS REQUIRED FOR IN-SLAB REFRIGERATION LINES AND SLEEVES THROUGH FLOOR, CEILING, OR WALLS, ARE NOT THE RESPONSIBILITY OF KITCHEN EQUIPMENT CONTRACTOR.

5. ELECTRICIANS TO SUPPLY SEPARATELY FUSED CIRCUIT, AVAILABLE 24 HOURS PER DAY FOR CONTROL CIRCUIT ON EXHAUST VENTILATOR AND INTERWIRE SEPARATE COMPONENTS.

6. ELECTRICIANS TO CONNECT WIRING TO REFRIGERATOR CONDENSING UNITS, INCLUDING CONTROL WIRING.

7. PLUMBER TO ENSURE A PRESSURE REDUCING VALVE, SET AT 20 TO 30 LBS. PER SQUARE INCH FLOW PRESSURE, IS INSTALLED IN HOT WATER LINE TO THE BOOSTER AND THAT AN AIR CUSHION EXPANSION CHAMBER IS INSTALLED BETWEEN THIS PRESSURE REDUCING VALVE AND THE DISHWASHER. ALSO PLUMB IN VENTILATOR GAS SOLENOID, IF ANY.

8. THE VENTILATION SYSTEM WILL BE EXHAUSTING 3700 CFM OF AIR AND IT IS NECESSARY THAT 80% OR 2960 CFM OF AIR BE REPLACED IN THE KITCHEN, IN ORDER THAT THE VENTILATION WORKS AT 100% EFFICIENCY. IT IS ADVISABLE THAT YOU WORK WITH YOUR AIR CONDITIONING OR HEATING CONTRACTOR TO INSTALL A MAKE-UP AIR UNIT IN YOUR PREMISES.

9. ALL SERVICES FOR EQUIPMENT SUPPLIED BY OTHERS/OWNER SHOULD BE CONFIRMED BY OTHERS.

10. PLUMBING CONTRACTOR TO PROVIDE WATER SUPPLY AND WASTE SERVICES FOR REFRIGERATION EVAPORATIVE WATER COOLER, PROVIDE BACK FLOW PREVENTION ASSEMBLY ON WATER SUPPLY LINE. PLUMBING CONTRACTOR TO MAKE ALL FINAL CONNECTION. CONDENSATE LINES TO BE SUPPLIED AND INSTALLED AT A MAXIMUM POSSIBLE SLOPE.

11. PLUMBING CONTRACTOR TO BRING ADEQUATELY SIZED GAS LINE DOWN, WHERE SHOWN, INSTALL GAS SAFETY SHUT-OFF VALVE (SUPPLIED BY KEC) AND THAN HOOK-UP ITEMS #3 (2ea CONNECTIONS REQUIRED), #5 & #7.

12. GENERAL CONTRACTOR TO SUPPLY AND INSTALL GUM BOXES AND REFRIGERATION SLEEPERS ON ROOF.

SYMBOL LEGEND	
MECHANICAL	ELECTRICAL
⊕ WASTE	⊖ SINGLE PURPOSE RECEPTACLE
○ COLD WATER	⊖ DUPLEX RECEPTACLE
● HOT WATER	⬆ SPECIAL PURPOSE RECEPTACLE
⊖ FLOOR DRAIN	Ⓜ JUNCTION BOX
⊖ FUNNEL FLOOR DRAIN	Ⓛ LIGHT
⊖ HUB DRAIN	Ⓛ SINGLE PHASE WIRED IN
⊖ GAS CONNECTION	Ⓛ THREE PHASE WIRED IN
Ⓛ DUCT CONNECTION	Ⓛ UTILITY OUTLET
Ⓛ REFRIGERATION /POP SLEEVE	Ⓛ FIELD WIRING BY DIV. 16 (ELECTRICAL)

DATE:	REVISIONS:
2017/01/06	PRELIMINARY LAYOUT ISSUED
2017/01/17	DRAWINGS UPDATED AS PER MARK UP
2017/02/06	DRAWINGS UPDATED AS PER MARK UP
2017/03/27	DRAWINGS ISSUED TO ARCH. FOR REVIEW

DATE:	2017/03/27
SCALE:	1:50
DESIGN:	A.U.
DRAWN:	A.U.
FILE NO.:	434/01/2017

PROJECT:

EQUIPMENT LAYOUT
FOR
"PRCC"
PEACE RIVER, AB

KE 1/2



HOTEL EQUIPMENT & SUPPLY CO. (2006) LTD.
13421 St. Albert Trail NW
EDMONTON, ALBERTA
T5L 4X1
Tel: (780) 429-2727 Fax: (780) 428-0782
Email: aungarian@hesco.ca

COPYRIGHT RESERVED. THIS DRAWING IS THE PROPERTY OF HESCO AND IS LOANED SUBJECT TO THE CONDITION THAT IT IS NOT TO BE COPIED, REPRODUCED, OR DISTRIBUTED, EITHER IN WHOLE OR IN PART, AND IS NOT TO BE USED DIRECTLY, OR INDIRECTLY, EXCEPT WITH THE AUTHORITY OF HESCO.





















UPPER LOBBY

UPPER LOBBY

200

UPPER LOBBY
200

SYMBOL LEGEND

<u>MECHANICAL</u>	<u>ELECTRICAL</u>
 WASTE	 SINGLE PURPOSE RECEPTACLE
 COLD WATER	 DUPLEX RECEPTACLE
 HOT WATER	 SPECIAL PURPOSE RECEPTACLE
 FLOOR DRAIN	 JUNCTION BOX
 FUNNEL FLOOR DRAIN	 LIGHT
 HUB DRAIN	 SINGLE PHASE WIRED IN
 GAS CONNECTION	 THREE PHASE WIRED IN
 DUCT CONNECTION	 UTILITY OUTLET
 REFRIGERATION /POP SLEEVE	 FIELD WIRING BY DIV. 16 (ELECTRICAL)

DATE:	REVISIONS:	DATE:	2017/03/27
2017/01/06	PRELIMINARY LAYOUT ISSUED	SCALE:	1:50
2017/01/17	DRAWINGS UPDATED AS PER MARK UP	DESIGN:	A.U.
2017/02/06	DRAWINGS UPDATED AS PER MARK UP	DRAWN:	A.U.
2017/03/27	DRAWINGS ISSUED TO ARCH. FOR REVIEW	FILE NO.:	434/01/2017

COPYRIGHT RESERVED. THIS DRAWING IS THE PROPERTY OF HESCO AND IS LOANED SUBJECT TO THE CONDITION THAT IT IS NOT TO BE COPIED, REPRODUCED, OR DISTRIBUTED, EITHER IN WHOLE OR IN PART, AND IS NOT TO BE USED DIRECTLY, OR INDIRECTLY, EXCEPT WITH THE AUTHORITY OF HESCO.

PROJECT:
EQUIPMENT LAYOUT
FOR
"PRCC"
PEACE RIVER, AB
KE 2/



HESCO

HOTEL EQUIPMENT & SUPPLY CO. (2006) LTD.

13421 St. Albert Trail NW
EDMONTON, ALBERTA
T5L 4X1

Tel: (780) 429-2727 Fax: (780) 428-0782
Email: aungarian@hesco.ca